

JP 7- 6

Dimension

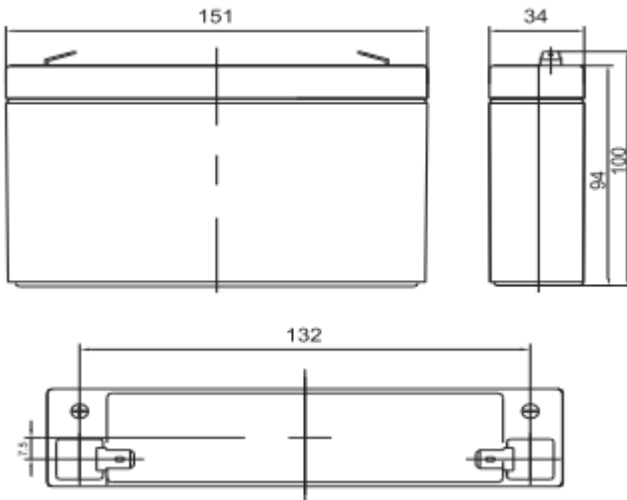

Specification

- ✎ Nominal Voltage : 6V
- ✎ Dimension
 - Length : 151±1.5mm(5.94inch)
 - Width : 34±1mm(1.34inch)
 - Overall Height : 100±1mm(3.94inch)
- ✎ Weight (Approx.) : 1.1kg(2.31lbs)±4%
- ✎ Nominal Capacity : 7 AH / 20HR (25°C)
- ✎ Internal Resistance(Approx.) : < 2.3 mΩ
- ✎ Float Charging : 6.75V - 6.90V (25°C)
- ✎ Cycle Charging : 7.25V - 7.30V (25°C)
- ✎ Terminal :
 - Top terminal : F1/F2
- ✎ Operating Temperature Range
 - Discharging : -15°C to 50°C
 - Charging : -10°C to 50°C
 - Storage : -20°C to 50°C
- ✎ Expected float use life (20°C) : 5 Years
- ✎ Easy Maintenance
 - No electrolyte leakage
 - Ensure safe and efficient operation
- ✎ Container Material : ABS
- ✎ Applications :
 - CCTV, CATV, Fiber Optic Communications
 - Emergency Lighting (lampu darurat, dll)
 - Fire Alarm, Elevators dll.
 - Security Systems
 - Toys and Models (mainan anak, dll)
 - UPS system (Computer/Server, ATM, dll)

Constant Current Discharge Characteristics Unit:A(25°C,77°F)

| F.V/Time | 5min | 10min | 15min | 30min | 60min | 2h | 3h | 4h | 5h | 10h | 20h |
|----------|------|-------|-------|-------|-------|------|------|------|------|------|------|
| 4.80V | 26.7 | 16.9 | 13.2 | 7.46 | 4.59 | 2.51 | 1.74 | 1.45 | 1.22 | 0.66 | 0.36 |
| 4.95V | 25.9 | 16.4 | 12.9 | 7.31 | 4.52 | 2.49 | 1.72 | 1.43 | 1.21 | 0.66 | 0.35 |
| 5.10V | 24.9 | 15.8 | 12.4 | 7.08 | 4.40 | 2.47 | 1.71 | 1.42 | 1.21 | 0.66 | 0.35 |
| 5.25V | 23.8 | 15.1 | 12.0 | 6.91 | 4.31 | 2.43 | 1.70 | 1.41 | 1.20 | 0.65 | 0.35 |
| 5.40V | 22.5 | 14.2 | 11.4 | 6.66 | 4.18 | 2.37 | 1.65 | 1.36 | 1.16 | 0.64 | 0.34 |

Constant Power Discharge Characteristics Unit:W(25°C,77°F)

| F.V/Time | 5min | 10min | 15min | 30min | 60min | 2h | 3h | 4h | 5h | 10h | 20h |
|----------|------|-------|-------|-------|-------|------|------|------|------|------|------|
| 4.80V | 149 | 95.5 | 75.4 | 42.7 | 26.5 | 14.7 | 10.3 | 8.55 | 7.29 | 3.98 | 2.13 |
| 4.95V | 145 | 92.7 | 73.6 | 41.9 | 26.1 | 14.6 | 10.2 | 8.50 | 7.25 | 3.96 | 2.12 |
| 5.10V | 139 | 88.9 | 70.9 | 40.6 | 25.5 | 14.5 | 10.2 | 8.44 | 7.20 | 3.94 | 2.11 |
| 5.25V | 133 | 85.0 | 68.5 | 39.6 | 25.0 | 14.2 | 10.1 | 8.38 | 7.15 | 3.92 | 2.10 |
| 5.40V | 125 | 80.3 | 64.9 | 38.1 | 24.2 | 13.9 | 9.80 | 8.13 | 6.93 | 3.84 | 2.06 |

Note: The above characteristics data can be obtained within three charge or discharge cycles.

Characteristics

Discharge Characteristics (25 C)

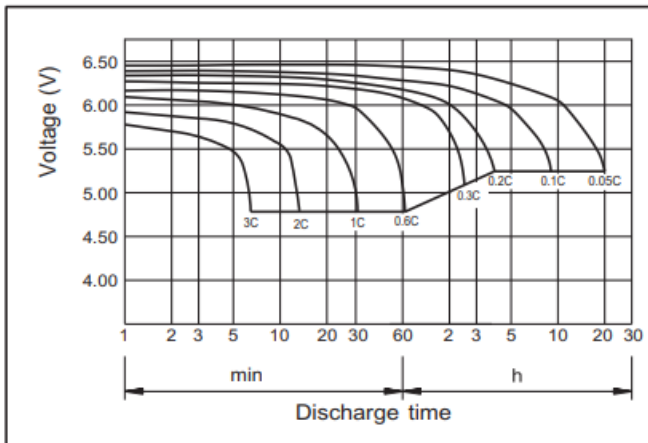

Charging Characteristics (25 C)

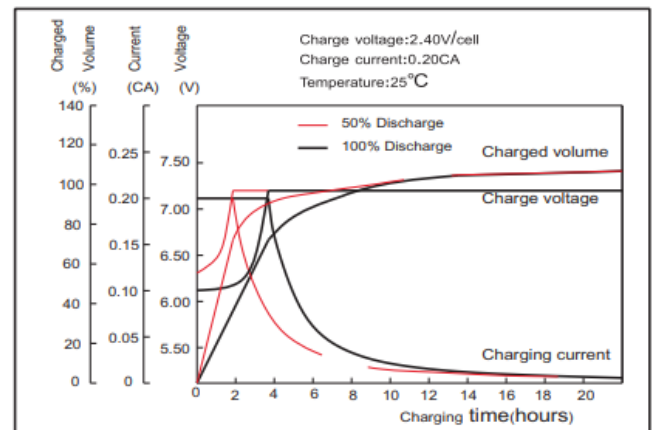

Effect of Temperature on Capacity

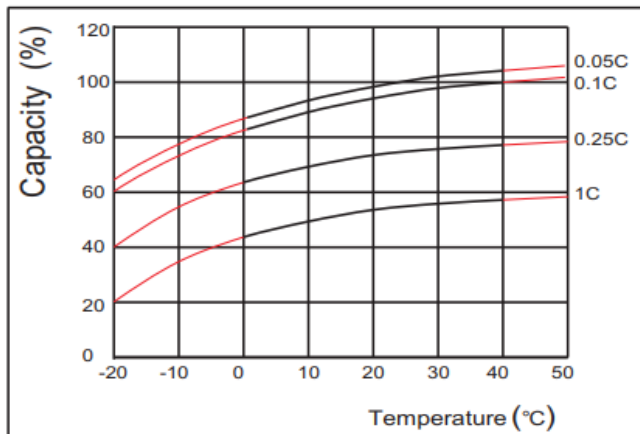

Self-Discharge Characteristic

